

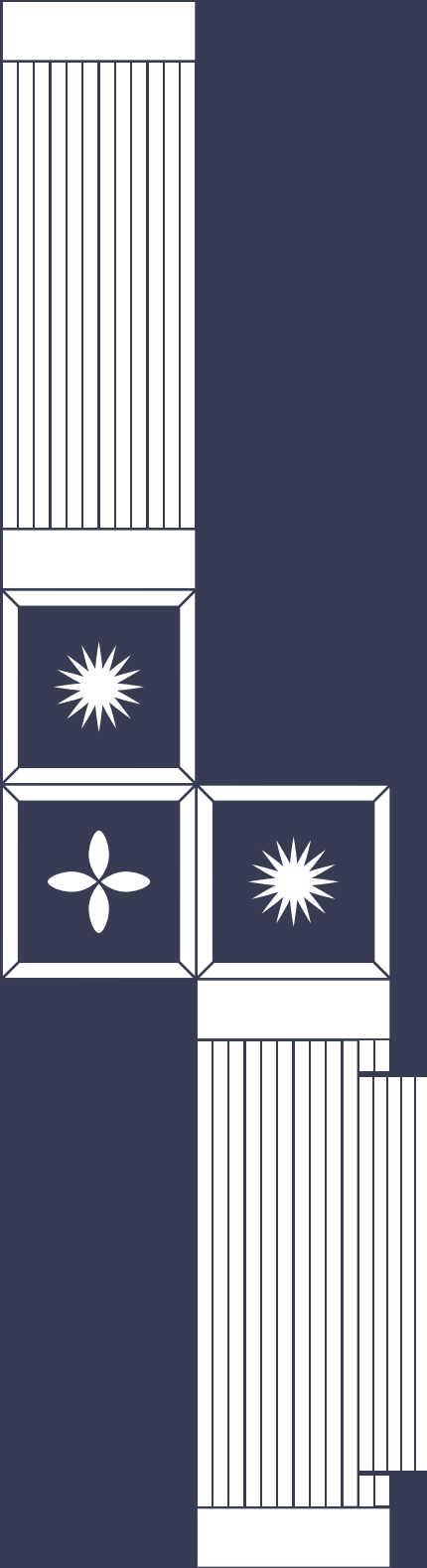

# NERI

Pictor  
Urban Furniture





**Discover Pictor urban furniture:  
a timeless collection that adapts  
to the lines of the city and those  
who live in it.**

**An essential but decisive product  
developed in collaboration with the  
Lombardini22 architecture studio.**

**The Pictor range includes:  
benches, planters, litter bins,  
bicycle racks and bollards.**

# A vast eco-friendly collection that puts man at the centre of its design.

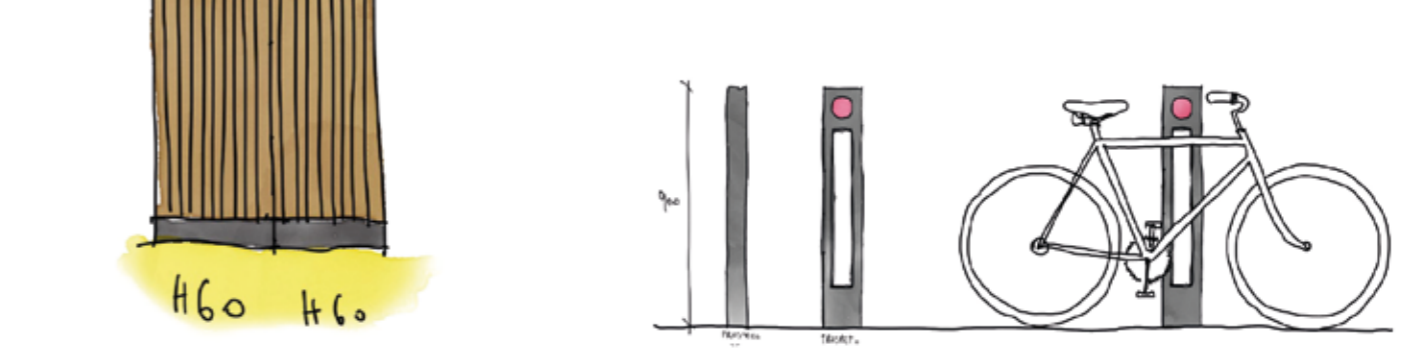
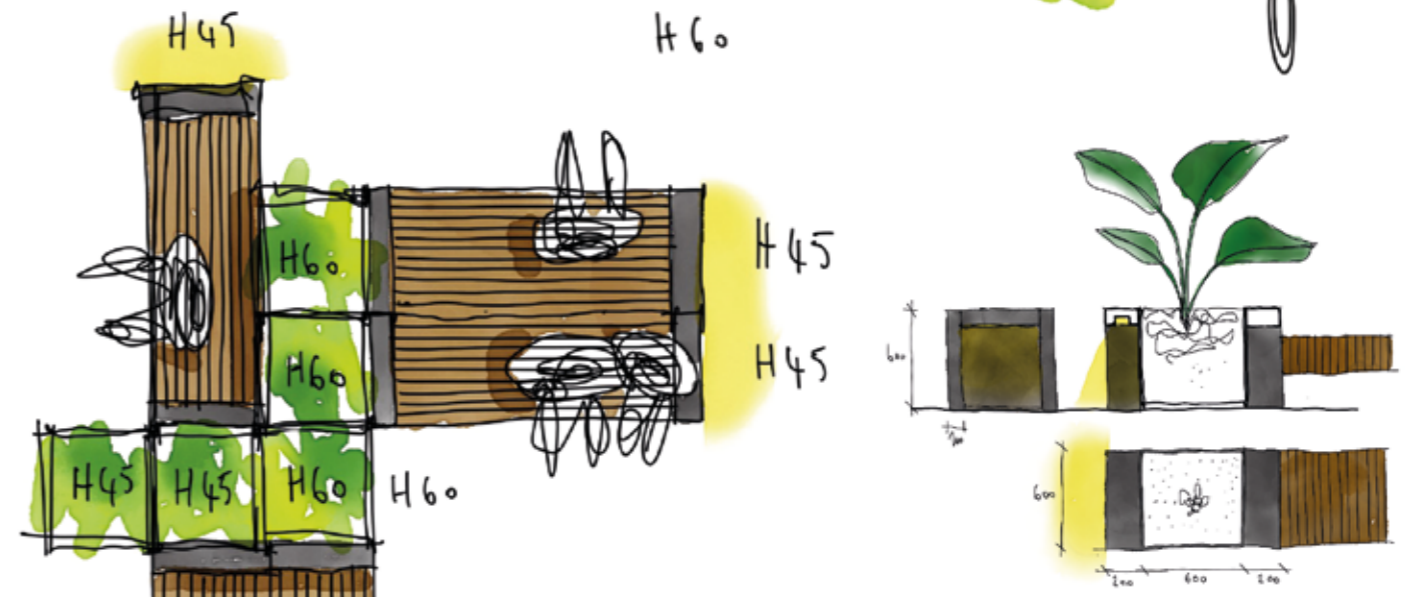
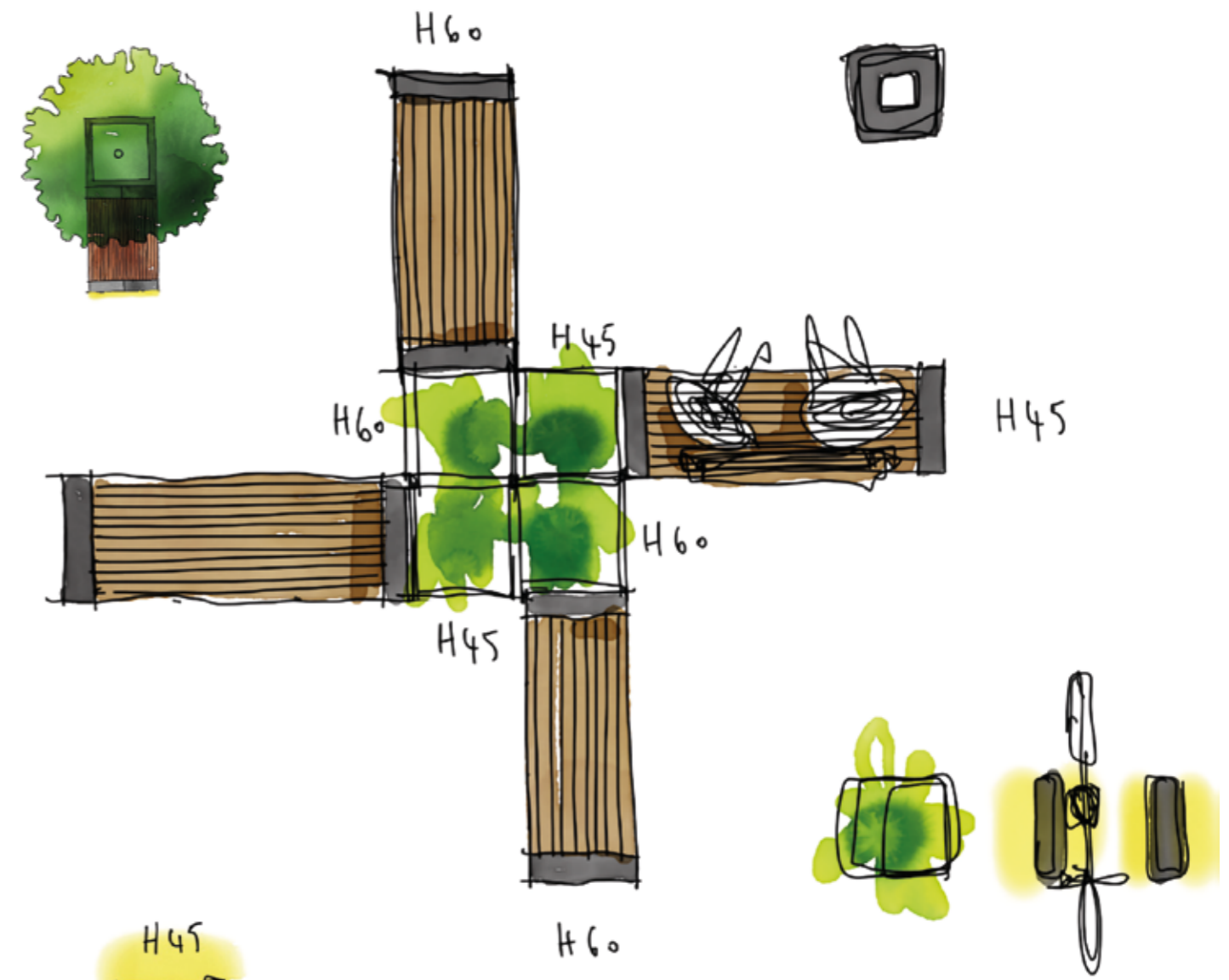
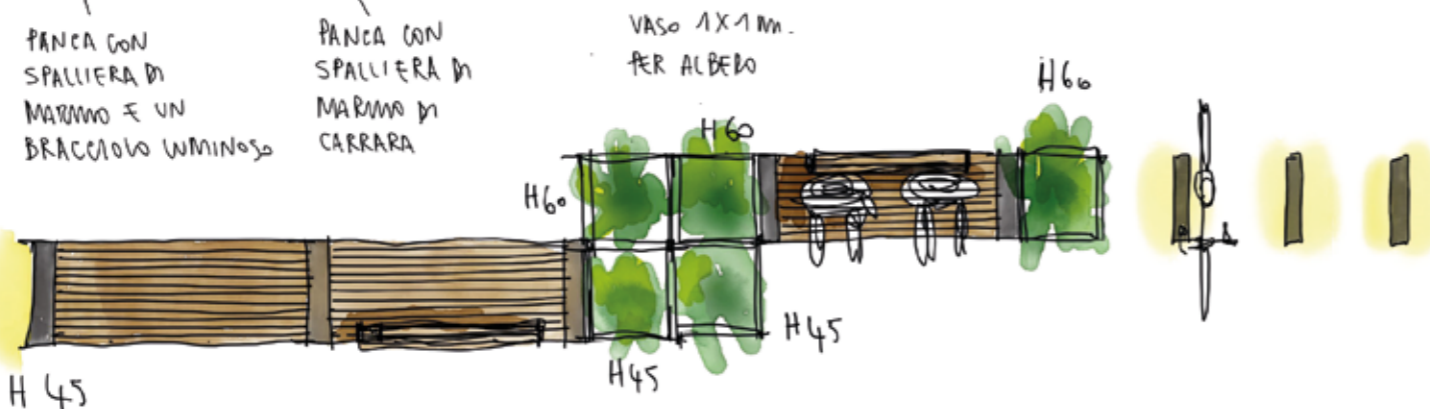
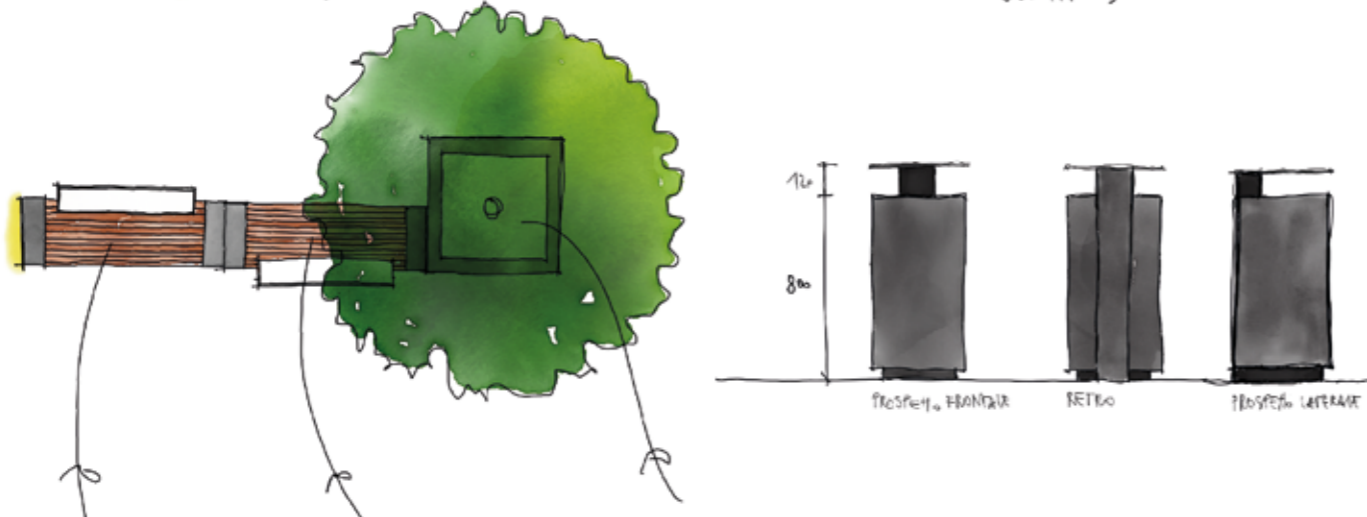
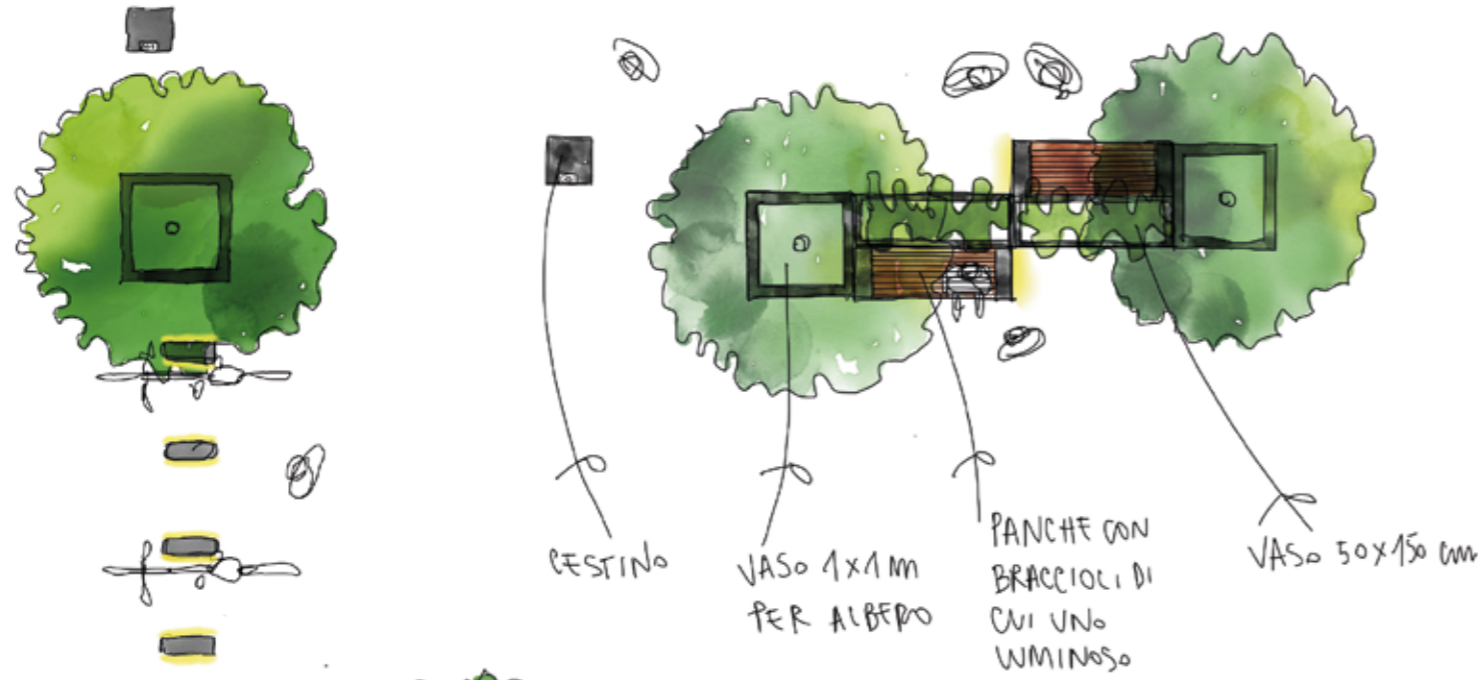

INFINITE COMBINATIONS

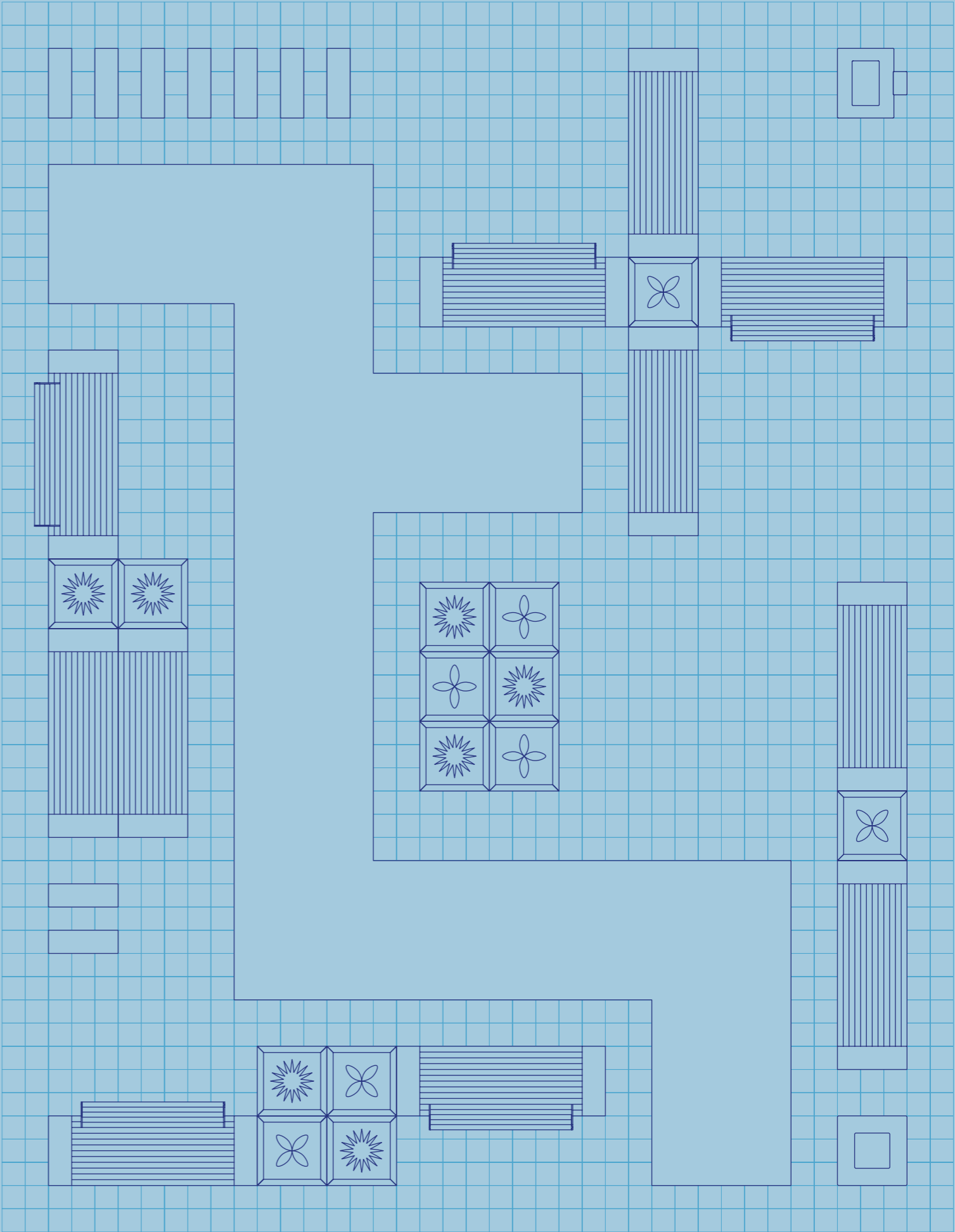
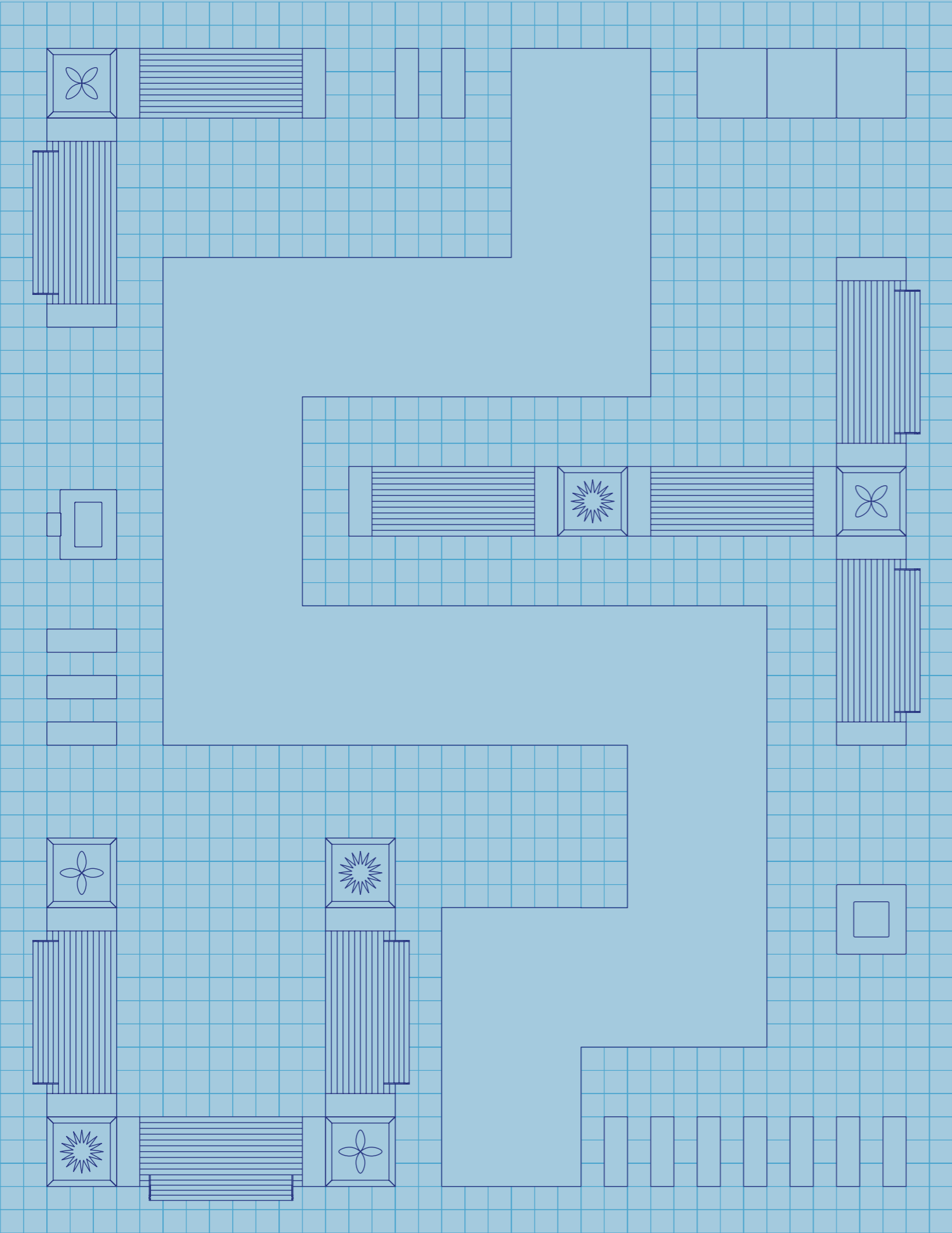



## PICTOR URBAN FURNITURE COLLECTION

Its strength lies in its modularity.

Pictor urban furniture offers an extraordinary constellation of design possibilities.



#### BENCH A

Bench without armrests: h 450mm

Seat made of FSC water-repellent wood planks or 100% certified renewable WPC planks.

#### BENCH B

Bench with armrests: h 600mm

Seat made of FSC water-repellent wood planks or 100% certified renewable WPC planks.

#### BENCH C / D

Bench with backrest (with or without armrests): h 796mm

Seat made of FSC water-repellent wood planks or 100% certified renewable WPC planks.

#### PLANTERS

Three types of planter: h 450mm / 600mm / 900mm

Square base made of painted stainless steel with four self-levelling feet.

#### LITTER BINS

Three types of litter bin: h 800mm / 909mm / 930mm

Square base bins with or without lid and post mounted bins in painted stainless steel.

#### BIKE RACKS AND BOLLARDS

Bicycle racks and railings: h 900mm

Made of painted steel. Designed to allow chains to pass through for attaching a bicycle.

## Pictor urban furniture: essential, decisive and versatile design.

The use of its modules,  
individually or in combination,  
invites the creative exploration of space,  
adapting to any environment and offering  
infinite visual connections.

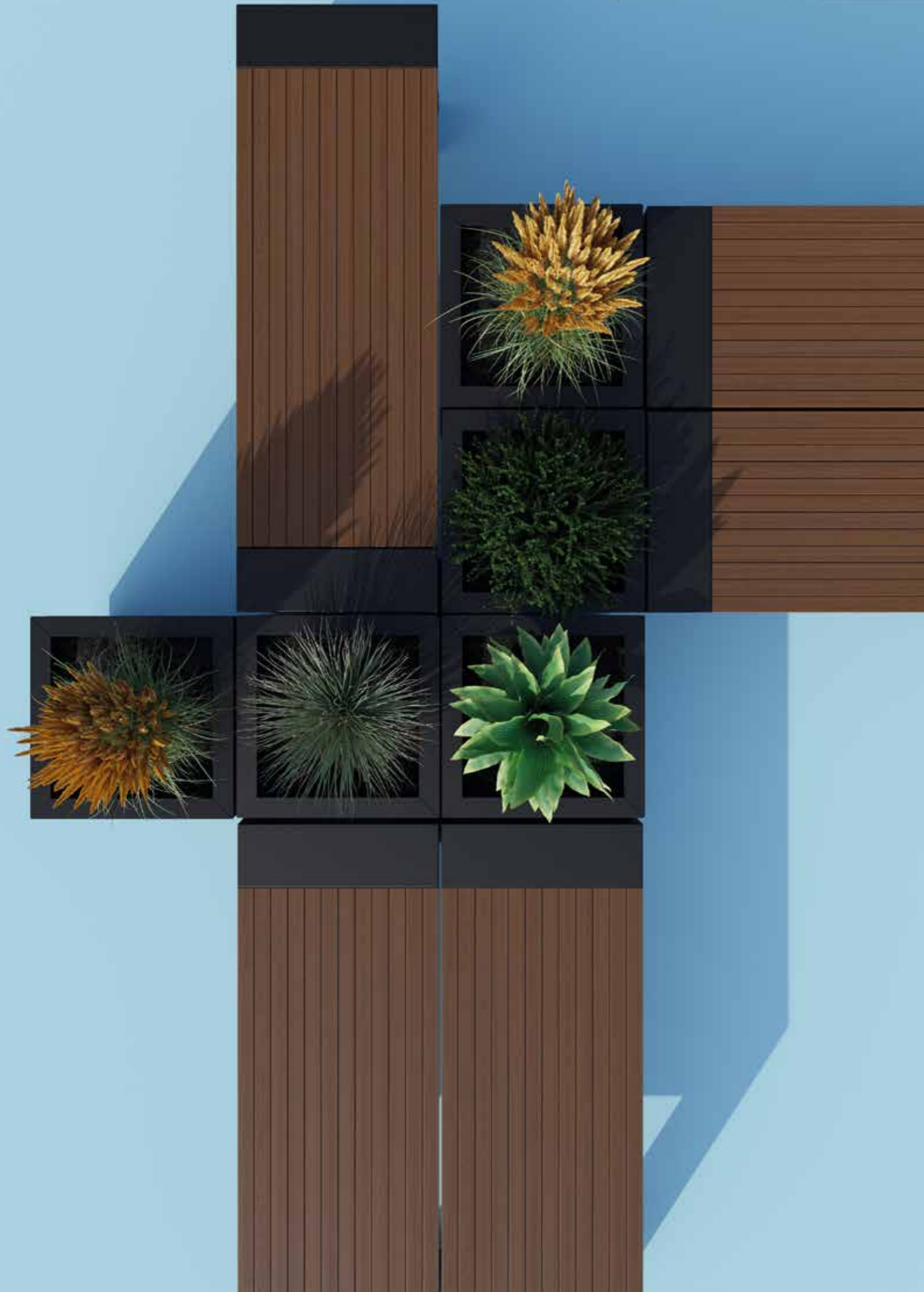

All Neri products can be  
customised on request.

Please contact the company for more information.

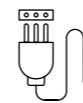

**Electric socket**  
Insertion within urban  
furniture of standard  
electrical sockets.

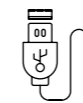

**USB port**  
Insertion within urban  
furniture of USB  
electrical sockets.

## SYSTEM CONFIGURATION

Materials and finishes to shape the Pictor urban furniture system.

### 1. FINISHES AND MATERIALS FOR BENCHES

Two finishes and two standard materials to customise the bench.



Gray Neri Finish



Corten Finish



Okumè Wood



WPC

#### CONFIGURATION OF LIGHTING AND CONTROL FEATURES

The Pictor system allows the installation of an LED module.

DIMENSIONS: 320mm x 80mm

COLOR TEMPERATURE: 3000K / 4000K / RGB

DRIVER FUNCTIONS: ON-OFF / DMX.

INSULATION CLASS: CLII – CLI

### 2. FINISHINGS FOR BICYCLE RACKS

Two standard finishes to customise the bollard.



Gray Neri Finish



Corten Finish

#### CONFIGURATION OF LIGHTING AND CONTROL FEATURES

The Pictor system allows the installation of an LED module.

DIMENSIONS: 320mm x 80mm

COLOR TEMPERATURE: 3000K / 4000K / RGB

DRIVER FUNCTIONS: ON-OFF / DMX.

INSULATION CLASS: CLII – CLI

### 3. FINISHES FOR PLANTERS, LITTER BINS, BOLLARDS

Two standard finishes to customise planters, litter bins and bollards.



Gray Neri Finish



Corten Finish





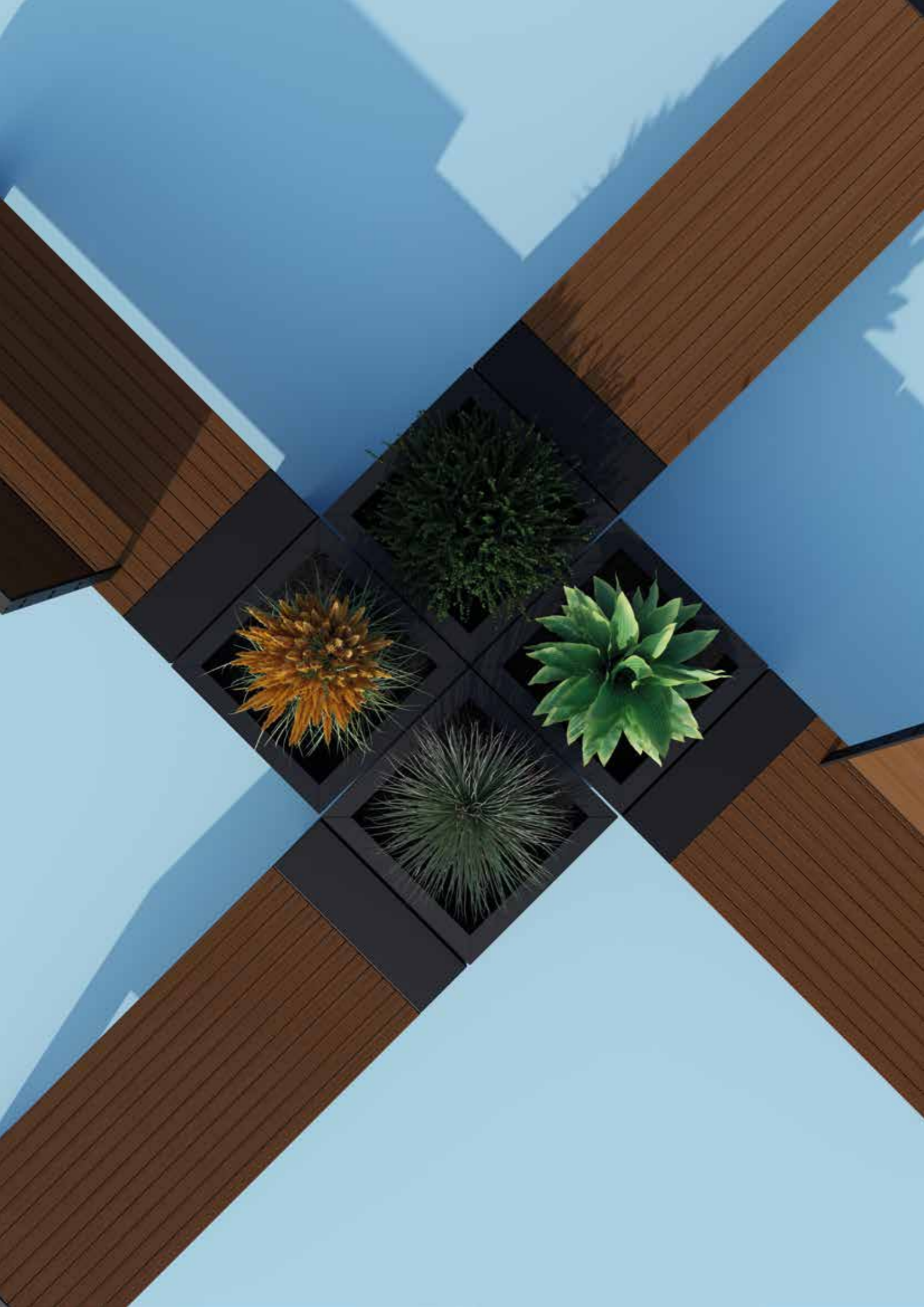

The Pictor urban furniture series is made of environmentally friendly components with respect for material circularity.

It uses organic and recycled elements and a scratch-resistant paint system that guarantees durability.

More details in the data sheets.

## PICTOR URBAN FURNITURE

## BENCH

## PICTOR URBAN FURNITURE

## BENCH WITH BACKREST

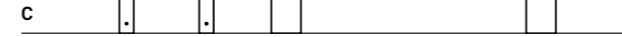

### Dimensions

<b>Lenght</b>
1.500mm [4' 11"]
<b>Width</b>
500mm [19 5/8"]
<b>Height</b>
450mm [17 6/8"]
<b>Weight</b>
89 kg [196.2 lb] / 94 kg [207.2 lb]

### Dimensions

<b>Lenght</b>
1.500mm [4' 11"]
<b>Width</b>
500mm [19 5/8"]
<b>Height</b>
600mm [23 5/8"]
<b>Weight</b>
94 kg [207.2 lb] / 100 kg [220.4 lb]

### Dimensions

<b>Lenght</b>
1.500mm [4' 11"]
<b>Width</b>
597mm [23 4/8"]
<b>Height</b>
796mm [31 3/8"]
<b>Weight</b>
103 kg [227 lb] / 109 kg [240.3 lb]

### Dimensions

<b>Lenght</b>
1.500mm [4' 11"]
<b>Width</b>
597mm [23 4/8"]
<b>Height</b>
796mm [31 3/8"]
<b>Weight</b>
108 kg [238 lb] / 115 kg [253.5 lb]

### PRODUCT DESCRIPTION

Bench composed of painted steel supports.  
Seat made of FSC-certified water-repellent wood planks or 100% recyclable WPC planks certified ReMade in Italy®.

### COMPONENTS A

160mm wide lateral supports made of S235 steel with Qualicoat2 polyester powder coating cycles, fitted with AISI 430 stainless steel perforated fixing brackets.

### COMPONENTS B

160mm wide lateral armrests made of S235 steel with Qualicoat2 polyester powder-painting cycles, fitted with AISI 430 stainless steel floor-mounted drilled fixing brackets.

### OKUMÈ WOOD / WPC

The seat is composed of a powder-coated S235 steel frame with pre-assembled 1200mm [3' 11 1/4"] long Okumè wood planks that have been treated with transparent protective coats in order to show the grain of the product or with pre-assembled 1200mm [3' 11 1/4"] long WPC planks certified ReMade in Italy®; the seat is equipped with 6 stainless steel screws per side for fastening to the side brackets.

### NOTE

The wooden planks are already pre-assembled to the frame.

### MATERIALS

- S235 Steel
- Stainless steel Aisi 430
- Okumè Wood / WPC

Refer to the specific descriptions on the paint cycles of the materials that make up the product.

### FINISHES

The standard colours are:  
- Neri Grey  
- Corten  
Other colours are available on request.

### LED MODULE

The Pictor system allows the installation of an LED module.

DIMENSIONS: 320mm x 80mm
COLOR TEMPERATURE: 3000K / 4000K / RGB
DRIVER FUNCTIONS: ON-OFF / DMX.
INSULATION CLASS: CLII – CLI

### INSTALLATION

Please refer to the product installation guide.

### PRODUCT DESCRIPTION

Bench composed of painted steel supports.  
Seat made of FSC-certified water-repellent wood planks or 100% recyclable WPC planks certified ReMade in Italy®.

### COMPONENTS C

160mm wide lateral supports made of S235 steel with Qualicoat2 polyester powder coating cycles, fitted with AISI 430 stainless steel perforated fixing brackets.

### COMPONENTS D

160mm wide lateral armrests made of S235 steel with Qualicoat2 polyester powder-painting cycles, fitted with AISI 430 stainless steel floor-mounted drilled fixing brackets.

### OKUMÈ WOOD / WPC

The seat is composed of a powder-coated S235 steel frame with pre-assembled 1200mm [3' 11 1/4"] long Okumè wood planks that have been treated with transparent protective coats in order to show the grain of the product or with pre-assembled 1200mm [3' 11 1/4"] long WPC planks certified ReMade in Italy®; the seat is equipped with 6 stainless steel screws per side for fastening to the side brackets.

The backrest is composed of a powder-coated S235 steel frame with pre-assembled 1000mm [3' 3 1/4"] long Okumè wood planks that have been treated with transparent protective coats in order to show the grain of the product or with pre-assembled 1000mm [3' 3 1/4"] long WPC planks certified ReMade in Italy®; the backrest is equipped with 4 stainless steel screws per side for fastening to the side brackets.

### NOTE

The wooden planks are already pre-assembled to the frame.

### MATERIALS

- S235 Steel
- Stainless steel Aisi 430
- Okumè Wood / WPC

Refer to the specific descriptions on the paint cycles of the materials that make up the product.

### FINISHES

The standard colours are:  
- Neri Grey  
- Corten  
Other colours are available upon request.

### LED MODULE

The Pictor system allows the installation of an LED module.

DIMENSIONS: 320mm x 80mm
COLOR TEMPERATURE: 3000K / 4000K / RGB
DRIVER FUNCTIONS: ON-OFF / DMX.
INSULATION CLASS: CLII – CLI

### INSTALLATION

Please refer to the product installation guide.

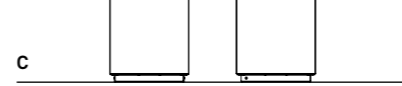
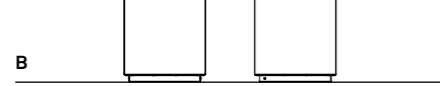
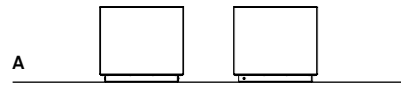

Dimensions	
<b>Lenght</b>	500 mm [19 5/8"]
<b>Width</b>	500mm [19 5/8"]
<b>Height</b>	450mm [17 6/8"]
<b>Capacity</b>	100 l [26.4 gal]
<b>Weight</b>	23 kg [50.7 lb]

Dimensions	
<b>Lenght</b>	500 mm [19 5/8"]
<b>Width</b>	500mm [19 5/8"]
<b>Height</b>	600 mm [23 5/8"]
<b>Capacity</b>	135 l [35.6 gal]
<b>Weight</b>	28 kg [61.7 lb]

Dimensions	
<b>Lenght</b>	500 mm [19 5/8"]
<b>Width</b>	500mm [19 5/8"]
<b>Height</b>	900 mm [35 3/8"]
<b>Capacity</b>	210 l [55.4 gal]
<b>Weight</b>	37 kg [81.5 lb]

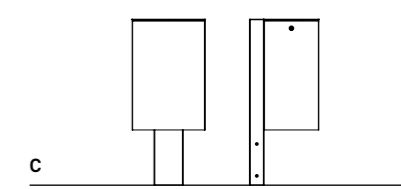
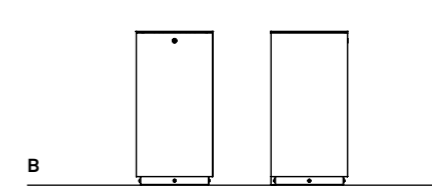
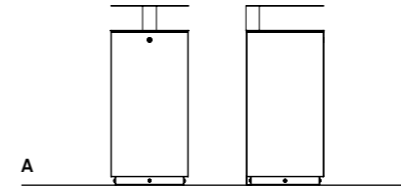

Dimensions	
<b>Lenght</b>	400 mm [15 6/8"]
<b>Width</b>	400 mm [15 6/8"]
<b>Height</b>	930 mm [31 4/8"]
<b>Capacity</b>	120 l [31.7 gal]
<b>Weight</b>	30 kg [66.14 lb]

Dimensions	
<b>Lenght</b>	400 mm [15 6/8"]
<b>Width</b>	400 mm [15 6/8"]
<b>Height</b>	800 mm [31 4/8"]
<b>Capacity</b>	120 l [31.7 gal]
<b>Weight</b>	29 kg [63.9 lb]

Dimensions	
<b>Lenght</b>	405 mm [16"]
<b>Width</b>	382 mm [15"]
<b>Height</b>	909 mm [35 6/8"]
<b>Capacity</b>	70 l [18.4 gal]
<b>Weight</b>	27 kg [59.5 lb]

**PRODUCT DESCRIPTION**

Square base planter made of painted stainless steel with four self-leveling feet to adapt to the floor.

**COMPONENTS**

Body in Aisi 430 stainless steel (2 mm [5/64"] thick) with reinforced base, powder-coated with Qualicoat2 polyester. The body is fixed to an Aisi 304 stainless steel base (2 mm [5/64"] thick) with a Scotch Brite finish. Inside the planter are four self-leveling feet.

**MATERIALS**

- Stainless steel Aisi 304  
 - Stainless steel Aisi 430  
 Refer to the specific descriptions on the paint cycles of the materials that make up the product.

**FINISHES**

The standard colours are:  
 - Neri Grey  
 - Corten  
 Other colours are available upon request.

**INSTALLATION**

Please refer to the product installation guide.

**PRODUCT DESCRIPTION A / B**

Square-based litter bin in painted stainless steel. Lockable hinge-opening gearbox. Stainless steel inner bag holder with hinge and elastic band for easy attachment and removal. A "separate collection" option is available.

**COMPONENTS A / B**

Body in Aisi 430 stainless steel (1.5 mm [4/64"] thick) powder-coated with Qualicoat2 polyester fixed to an Aisi 304 stainless steel base with Scotch Brite finish (2 mm [5/64"] thick); can be installed using dowels. Inside the basket is a stainless steel bag holder (3 mm [8/64"] thick) which can rotate to facilitate bag installation and removal. An elastic cord is attached to the bag holder to secure the bag. The body is equipped with a vandal-proof key lock for locking the gearbox. Stainless steel gearbox (3 mm [8/64"] thick) powder-coated with Qualicoat2 polyester. The gearbox is mounted with two concealed screws inside the body, which allows it to serve as an interchangeable lid for waste collection. Stainless steel lid (3 mm [8/64"] thick) or removable ashtray attached to the body by means of an anti-theft cable.

**MATERIALS A / B**

- Stainless steel Aisi 304  
 - Stainless steel Aisi 430  
 Refer to the specific descriptions on the paint cycles of the materials that make up the product.

**FINISHES**

The standard colours are:  
 - Neri Grey  
 - Corten  
 Other colours are available upon request.

**INSTALLATION**

Please refer to the product installation guide.

**PRODUCT DESCRIPTION C**

Litter bin on post, rectangular painted stainless steel base. Stainless steel inner bag holder with hinge and elastic band for easy attachment and removal.

**COMPONENTS C**

Body in AISI 430 stainless steel (1.5 mm [4/64"] thick) powder-coated with Qualicoat2 polyester powders fixed to a post with dimensions 160x80 made of S235 steel with Qualicoat2 polyester powder-coating cycles, fitted with a drilled ground fixing stirrup in AISI 430 stainless steel. Inside the basket is a stainless steel bag holder (3 mm [8/64"] thick) which can rotate to facilitate bag installation and removal. An elastic cord is attached to the bag holder to secure the bag. The body is equipped with a vandal-proof key lock for locking the gearbox. Stainless steel gearbox (3 mm [8/64"] thick) powder-coated with Qualicoat2 polyester. Stainless steel lid (3 mm [8/64"] thick) or removable ashtray attached to the body by means of an anti-theft cable.

**MATERIALS C**

- Stainless steel Aisi 304  
 - Stainless steel Aisi 430  
 Refer to the specific descriptions on the paint cycles of the materials that make up the product.

**FINISHES**

The standard colours are:  
 - Neri Grey  
 - Corten  
 Other colours are available upon request.

**INSTALLATION**

Please refer to the product installation guide.

## PICTOR URBAN FURNITURE

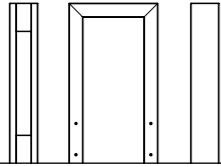

### Dimensions

**Lenght**

500 mm [19 5/8"]

**Width**

160 mm [6 2/8"]

**Height**

900 mm [35 3/8"]

**Weight**

29 kg [63.9 lb]

### PRODUCT DESCRIPTION

Painted steel bike rack/railing.

### COMPONENTS

Bridge structure made of S235 steel with Qualicoat2 polyester powder coating cycles, equipped with two AISI 430 stainless steel drilled ground fixing stirrups.

One of the two uprights is designed to allow chains to pass through for attaching a bicycle.

### NOTE

The product can be used both as a street railing and as a bicycle rack.

### MATERIALS

- Stainless steel Aisi 304
- Stainless steel Aisi 430

Refer to the specific descriptions on the paint cycles of the materials that make up the product.

### FINISHES

The standard colours are:

- Neri Grey
- Corten

Other colours are available upon request.

### LED MODULE

The Pictor system allows the installation of an LED module.

DIMENSIONS: 320mm x 80mm

COLOR TEMPERATURE: 3000K / 4000K / RGB

DRIVER FUNCTIONS: ON-OFF / DMX.

INSULATION CLASS: CLII – CLI

### INSTALLATION

Please refer to the product installation guide.

## BICYCLE RACK

## PICTOR URBAN FURNITURE

## BOLLARDS

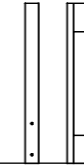

### Dimensions

**Lenght**

80 mm [3 1/8"]

**Width**

160 mm [6 2/8"]

**Height**

900 mm [35 3/8"]

**Weight**

13 kg [28.6 lb]

### PRODUCT DESCRIPTION

Painted steel bollard/bike rack.

### COMPONENTS

Structure made of S235 steel with Qualicoat2 polyester powder coating cycles, fitted with two AISI 430 stainless steel drilled ground fixing stirrups.

The upright is designed to allow chains to pass through for attaching a bicycle.

### NOTE

The product can be used both as a road bollard and as a bicycle rack.

### MATERIALS

- Stainless steel Aisi 304
- Stainless steel Aisi 430

Refer to the specific descriptions on the paint cycles of the materials that make up the product.

### FINISHES

The standard colours are:

- Neri Grey
- Corten

Other colours are available upon request.

### INSTALLATION

Please refer to the product installation guide.



**Pictor shapes  
the city by day  
and by night.**



# Complete Pictor urban furniture with the Pictor lighting system.

Find out more about the Pictor lighting system in the dedicated brochure.

8

7

6

5

4

3

2

1



 Pictor pole system  
h 500 cm  
double

 Pictor pole system  
h 400 cm  
single

 Pictor pole system  
h 600 cm  
double offset

Neri S.p.A.  
S.S. Emilia 1622  
47020 Longiano (FC) · Italy  
T +39 0547 652111

Neri North America Inc.  
250 Catalonia Ave, Ste. 804  
Coral Gables, FL 33134  
T +1 786 315 4367

Neri Lighting India Pvt. Ltd.  
Plot no 46-A, Malur 4th Phase,  
KIADB Industrial area,  
Malur – Karnataka · 563130

Neri S.p.A. (DMCC Branch)  
29-29 Reef Tower Cluster O  
JLT – Jumeirah Lake Towers  
P.O. Box: 5003348 · Dubai · UAE  
T +971 4 448 7246  
F +971 4 448 7112

[www.neri.biz](http://www.neri.biz)  
© November 2023 · Neri S.p.A.



